

🕒 Completion - OCT 2026

# Cove Edition 2

Dubailand



**Jan Petrovic**

Slovenia

 **Verified Agent**

Phone

+38640772980

Email

info@petrodeluxe.si

Website

Instagram:

 WhatsApp

 Email



**INTIAZ**  
DEVELOPMENTS

Intiaz Development

# Cove Edition 2

 Furnishing - Yes

 Parking -

 Floors - G + P +  
13floors + R

 Service charge - 15  
AED/sqft

## Project general facts

Cove Edition 2 by Imtiaz, located in the vibrant heart of Dubailand, elevates the art of luxury living to new heights. This exclusive community invites discerning residents to indulge in a refined lifestyle, crafted for those who value elegance and sophistication. Seamlessly blending timeless charm with contemporary design, Cove Edition 2 stands as a visionary landmark close to the city's finest schools, making it the perfect sanctuary for families.

Rising majestically against the Dubai skyline, Cove Edition 2 symbolizes modern architectural grace. Its lush green surroundings provide an exquisite connection between nature and urban luxury, offering residents a serene retreat from the bustling city. The infinity pool, with its uninterrupted horizon views, exudes a sense of infinite calm, balancing sleek design with relaxation. Whether lounging by the pool or taking a dip, residents enjoy a perfect harmony of style and tranquility in this carefully curated environment.

Inside, Cove Edition 2 offers a seamless blend of luxury and comfort. Studio apartments with custom furniture and soothing tones create a peaceful haven, while one- and two-bedroom residences combine aesthetics with functionality, offering an inviting space for dynamic, modern living. The rooftop cabanas and lounges provide

elegant spaces for relaxation and social gatherings, framed by stunning panoramic views. From the rooftop BBQ area to the state-of-the-art fitness facilities, every aspect of Cove Edition 2 promotes a holistic, luxurious lifestyle, where community and well-being flourish.

### **Finishing and materials**

Modern finishing with high-quality materials.

### **Kitchen and appliances**

Equipped kitchen.

### **Furnishing**

Fully furnished.

### **Location description and benefits**

Dubailand is one of Dubai's most ambitious and diverse districts, offering a unique blend of entertainment, residential communities, and leisure attractions. Spanning an impressive area, Dubailand is designed to cater to both residents and tourists, making it a dynamic destination for all. It features a variety of themed parks, sports facilities, shopping centers, and family-oriented attractions, positioning it as a key hub for entertainment in the city.

Among its iconic developments are the Global Village, IMG Worlds of Adventure, and Dubai Sports City, which collectively make it a vibrant, activity-packed zone.

As a residential area, Dubailand offers a wide range of housing options, from luxury villas to modern apartments, surrounded by parks, schools, and healthcare facilities. Designed to a balanced lifestyle, it attracts families and individuals who seek a serene, suburban atmosphere with easy access to the city's core. Its carefully planned communities, like Arabian Ranches and The Villa, are known for their greenery, open spaces, and family-friendly environments. The district is well-connected by major roads, making commuting to Downtown Dubai and other key areas seamless and convenient.

Dubailand is also a growing commercial and business hub, with ongoing developments that promise to further enhance its appeal. In addition to its entertainment and residential offerings, it is home to a range of educational institutions, fitness centers, and retail outlets, ensuring that residents have everything they need within reach. With its blend of leisure, modern living, and business opportunities, Dubailand is evolving into a complete and self-sustaining community, offering an exciting yet comfortable lifestyle in the heart of Dubai's ever-expanding landscape.



# Architecture





# Interior





# Location

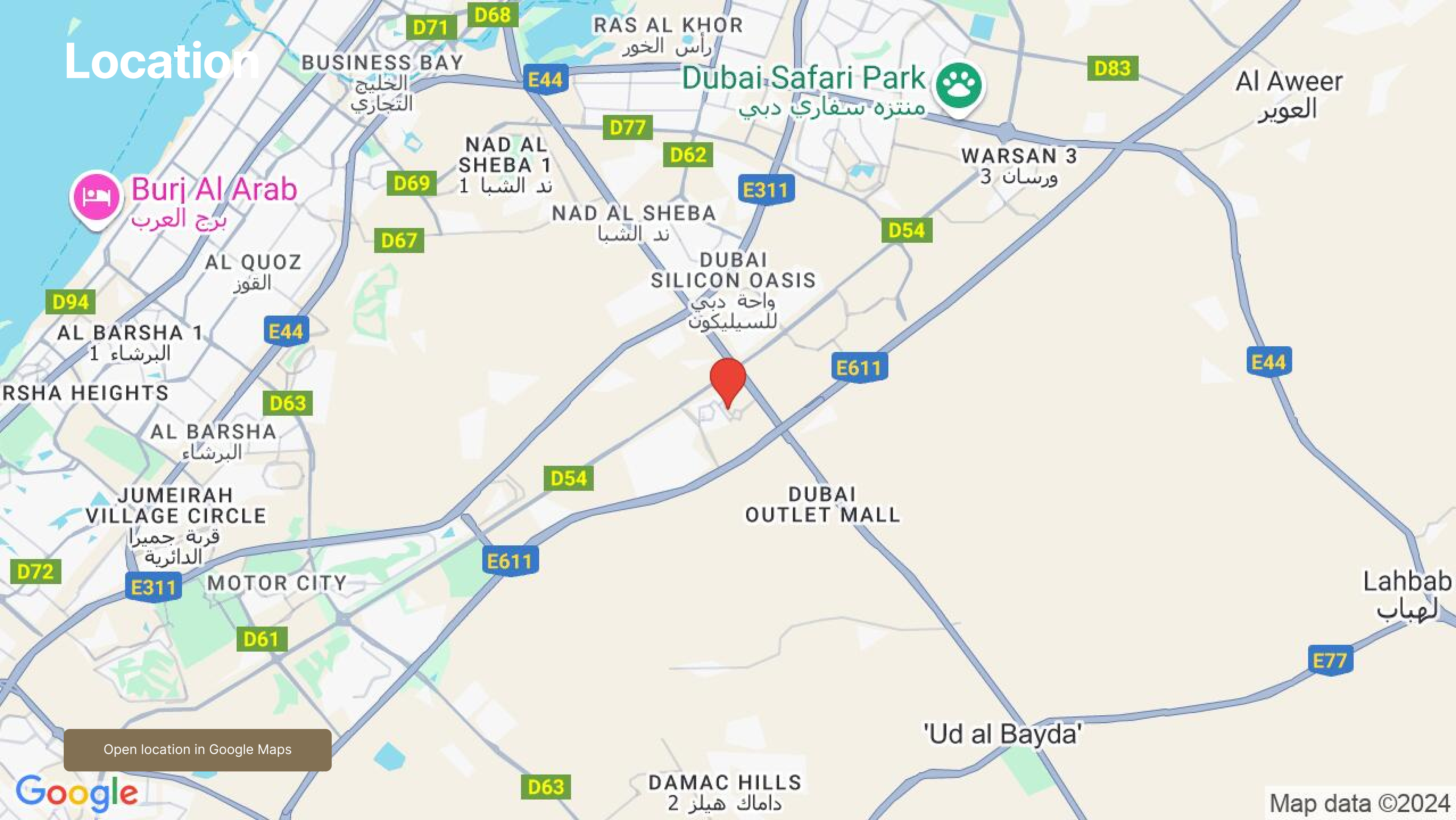

**Burj Al Arab**  
برج العرب

**Dubai Safari Park**  
منتزه سفاري دبي



Open location in Google Maps

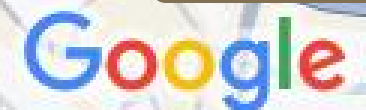

Map data ©2024

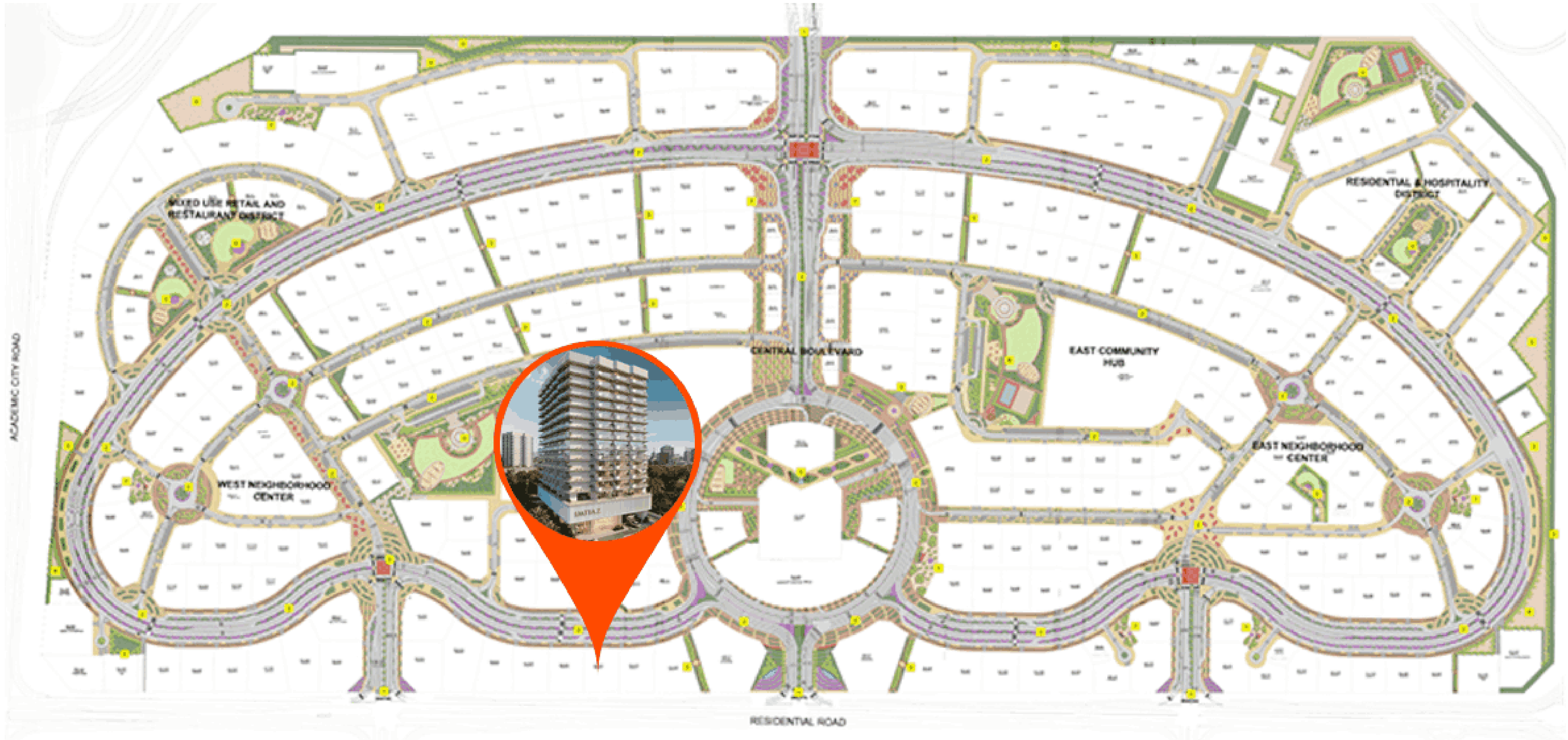



# Facilities



**Rooftop Swimming Pools**

Visualisation from developer



**Rooftop Lounges**

Visualisation from developer



**Cabanas**

Visualisation from developer



**Fully Equipped Gym**

Visualisation from developer



**Private Pool**

Visualisation from developer



**Kids Swimming Pool**

Visualisation from developer



**Club Room**

Visualisation from developer



**BBQ Area**

Visualisation from developer



# Payment plan



## Payment Plan

30% payment	On booking
20% payment	During construction
50% payment	Upon Handover

---

Condition for the unit resale

**Not specified**



## 3 Years Post Handover Payment Plan

20% payment	On booking
35% payment	During construction
15% payment	Upon Handover
30% payment	2.5% quarterly during 36 months PH

---

Condition for the unit resale

**Not specified**



# Typical units and prices

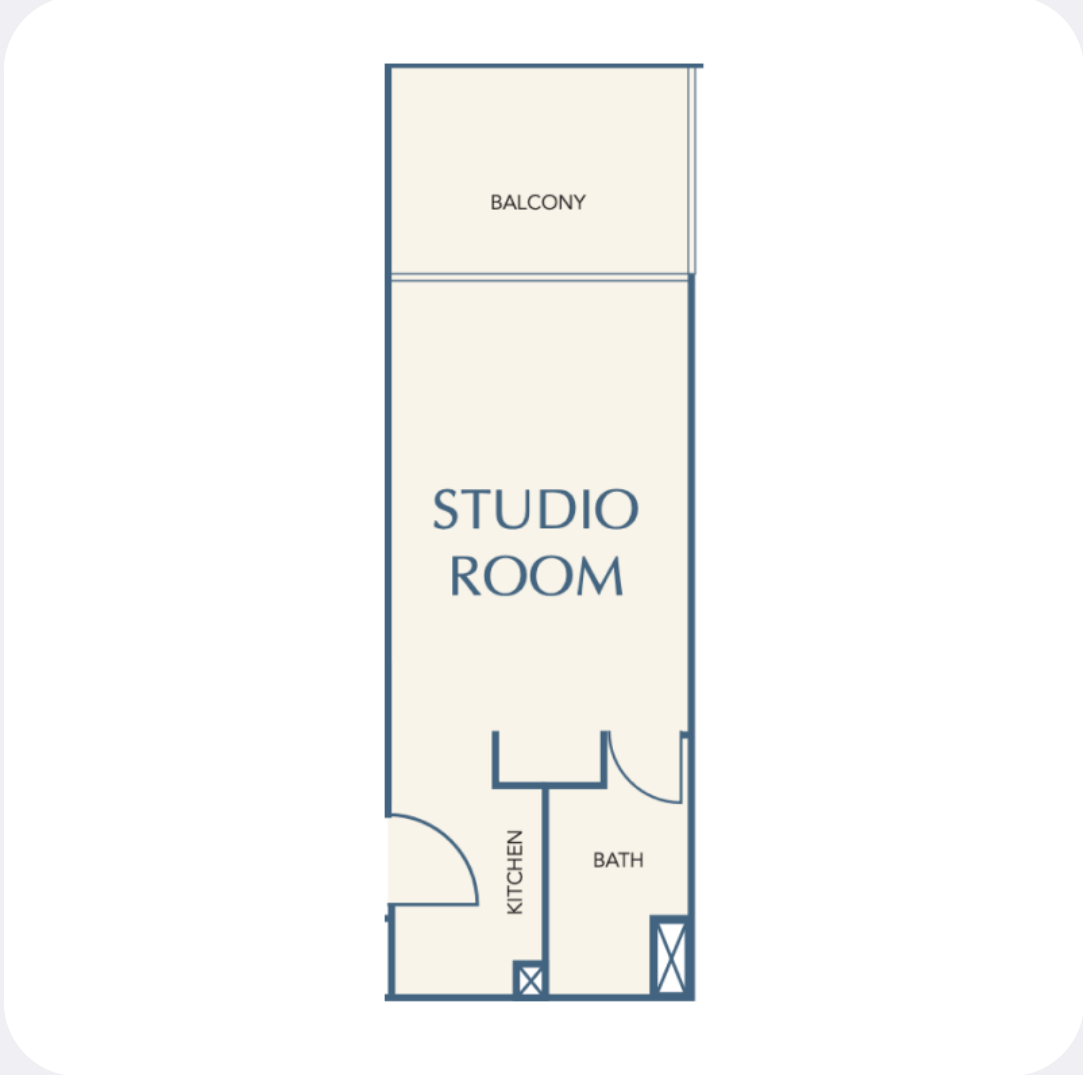

**Apartments**                      **Studio**

FROM  
**EUR 149,528**

382 sqft / 35 m<sup>2</sup>

TO  
**EUR 173,064**

447 sqft / 42 m<sup>2</sup>



**Apartments**                      **1 bedroom**

FROM  
**EUR 227,861**

742 sqft / 69 m<sup>2</sup>

TO  
**EUR 265,683**

1334 sqft / 124 m<sup>2</sup>



**Apartments**                      **2 bedroom**

FROM  
**EUR 314,146**

1174 sqft / 109 m<sup>2</sup>

TO  
**EUR 344,939**

1270 sqft / 118 m<sup>2</sup>



**Do you have any questions? Contact me.**



**Jan Petrovic**

Phone

+38640772980

Email

info@petrodeluxe.si

Instagram



WhatsApp



Email

