

🕒 Completion - Q3 2027

Como Residences

Palm Jumeirah



Jan Petrovic

Slovenia

🔒 Verified Agent

Phone

+38640772980

Email

info@petrodeluxe.si

Website

Instagram:

 WhatsApp

 Email



NAKHEEL

Nakheel

Como Residences

 Furnishing - No

 Parking -

 Floors - 71 floors

 Service charge -
30-35 AED/sqft

Project general facts

This water-inspired tower boasts 71 floors - each resembling a unique ocean wave. This is the latest chapter in Nakheel's ambitious vision for extraordinary waterfront life in Dubai. The statement structure is sculpted into a series vertical lakes, including a variety of communal pools and a selection of exclusive private pools. Explore sweeping terraces with glistening pools and verdant greenery, gaze out at breathtaking views over the sea and cityscape, and relax in wonderfully spacious homes with outstanding amenities. The exclusive collection of luxury apartments and exceptional amenity suite offers residents an ultra-chic, cosmopolitan lifestyle surrounded by art and beauty. Extremely spacious interiors lead out onto vast terraces embellished with lush greenery and unique private pools. Admire breathtaking views towards Burj Al Arab, Burj Khalifa, Palm Jumeirah, and Ain Dubai as you relax and breath in the fresh sea air. Each exclusive apartment enjoys either 180- or 360-degree panoramic views.

Finishing and materials

This exclusive collection of private residences offers a range of spacious layouts and exclusive features.

Kitchen and appliances

Equipped kitchen

Furnishing

No

Location description and benefits

Como Residences is an indelible addition to one of the world's largest man-made islands. Palm Jumeirah is pushing the boundaries to offer the utmost in beachfront allure. Discover the pinnacle of sophisticated beachfront living. This sleek, majestic tower rises above Palm Jumeirah, harmoniously blending into the world-renowned landscape of extravagant luxury resorts, high-end stores, entertainment venues and supreme dining destinations. From high-end shopping to glamorous events at luxury beach clubs, the best of Palm Jumeirah is at your fingertips.

Architecture



Architecture



Interior



Location

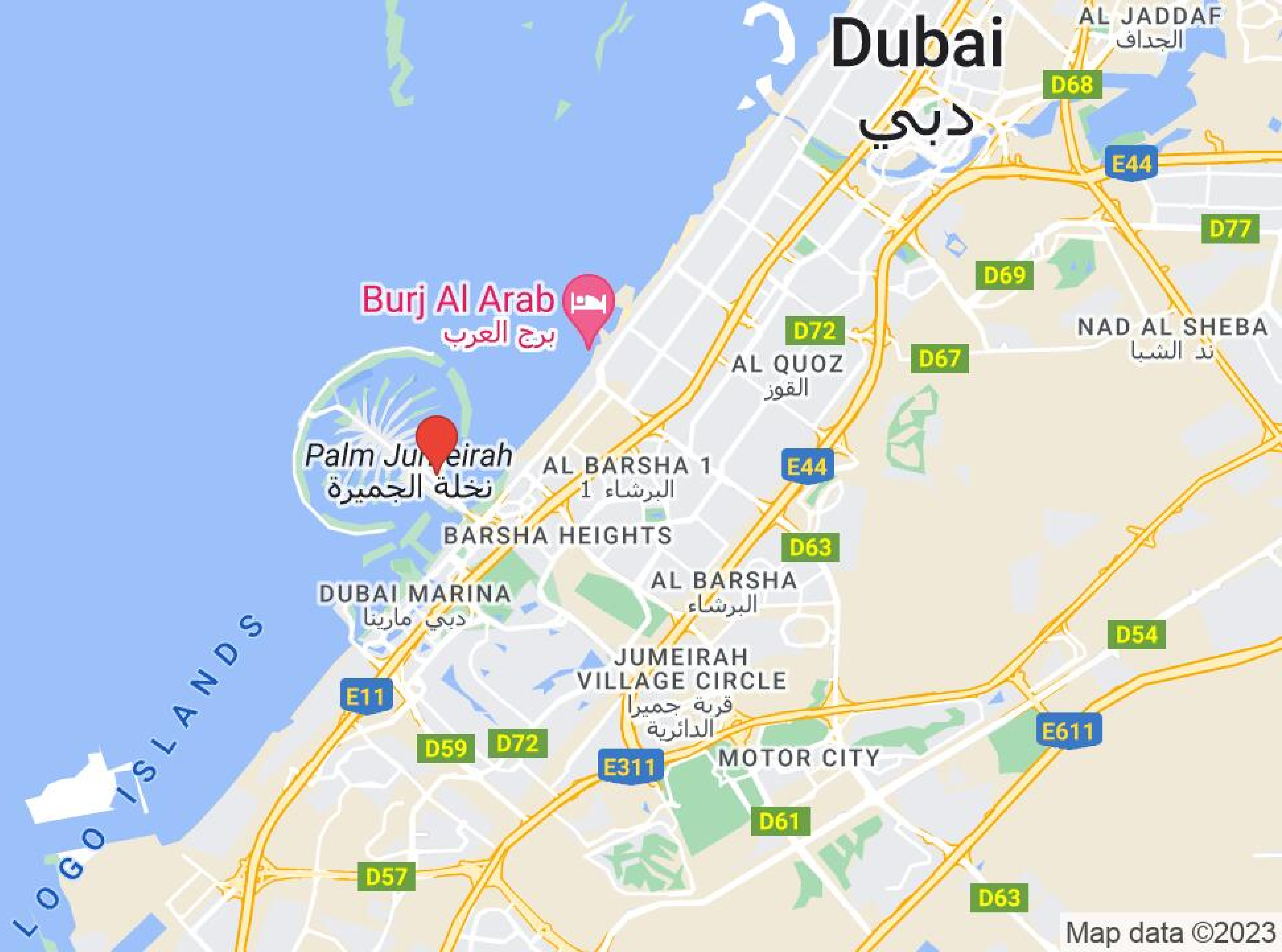

[Open location in Google Maps](#)



Facilities



**PRIVATE SANDY BEACH POOL
LOCATED AT THE PODIUM LEVEL**

Visualisation from developer



**DEDICATED 25M LAP SWIMMING
POOL**

Visualisation from developer



**LANDSCAPE RECREATIONAL
AREAS**

Visualisation from developer



**ROOFTOP AND 360 DEGREE
VIEWING AREA LOCATED ON
LEVEL 71 WITH AMENITIES**

Visualisation from developer



**PRIVATE SWIMMING POOLS FOR
SKY TERRACE APARTMENTS**

Visualisation from developer



**CHILDREN'S WET AND DRY PLAY
AREAS**

Image for general understanding



**PADDLE COURTS AND SQUASH
COURTS**

Image for general understanding



**GYMNASIUM, SPA AND WELLNESS
CENTER**

Image for general understanding

Facilities



PRIVATE CAFÉ LOUNGE

Image for general understanding



BUSINESS CENTER WITH MEETING ROOMS

Image for general understanding

Payment plan



Payment plan

20% payment	On booking
60% payment	During construction
20% payment	Upon Handover

Condition for the unit resale

30+4%

Typical units and prices

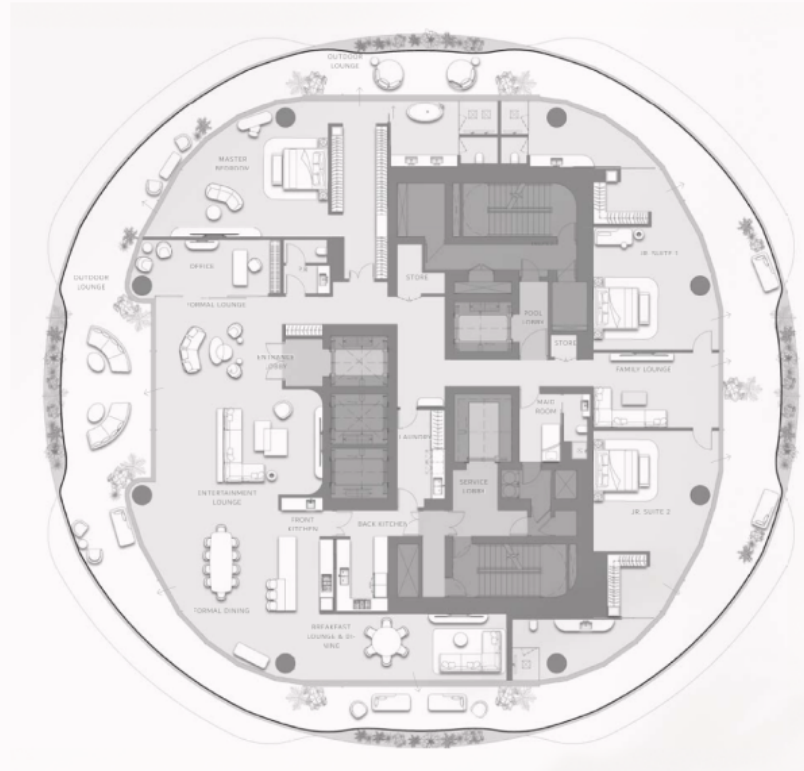

Apartments

3 bedroom

FROM

EUR 8,425,420

6502 sqft / 604 m²

TO

EUR 13,155,337

9379 sqft / 871 m²

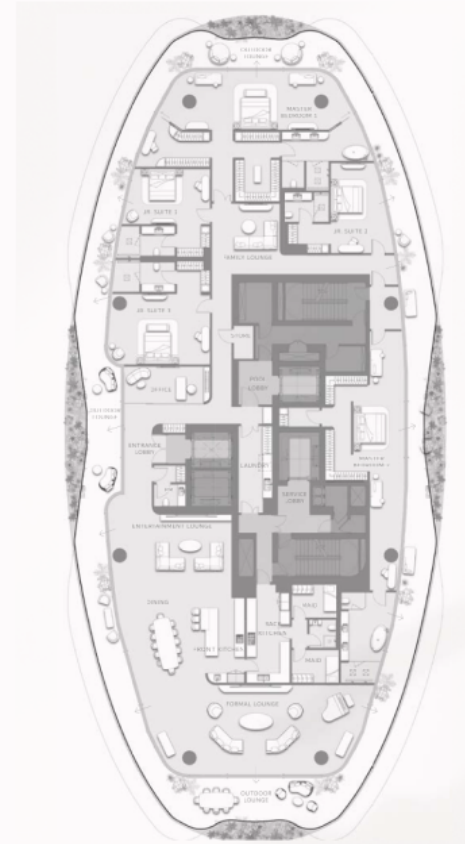

Apartments

5 bedroom

FROM

EUR 10,867,411

7707 sqft / 716 m²

TO

No info

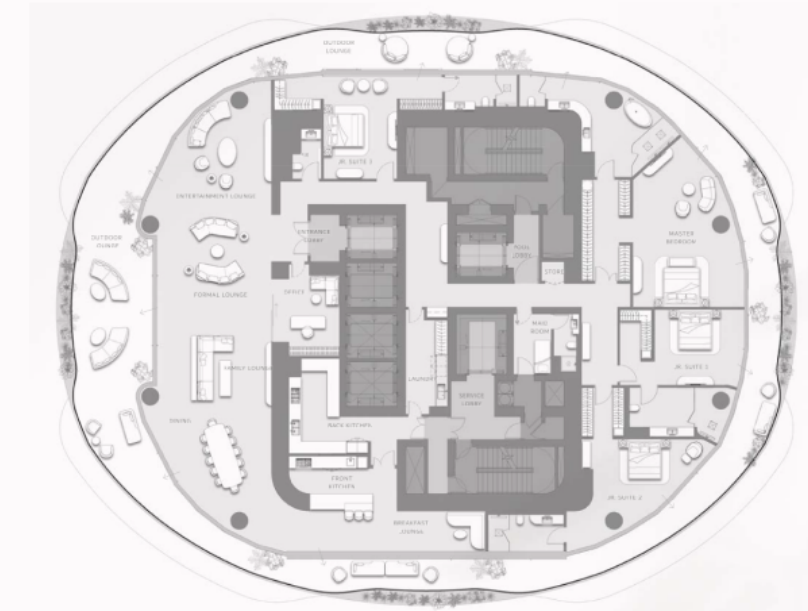

Apartments

4 bedroom

FROM

EUR 14,306,941

9823 sqft / 913 m²

TO

EUR 15,266,402

10299 sqft / 957 m²

Typical units and prices

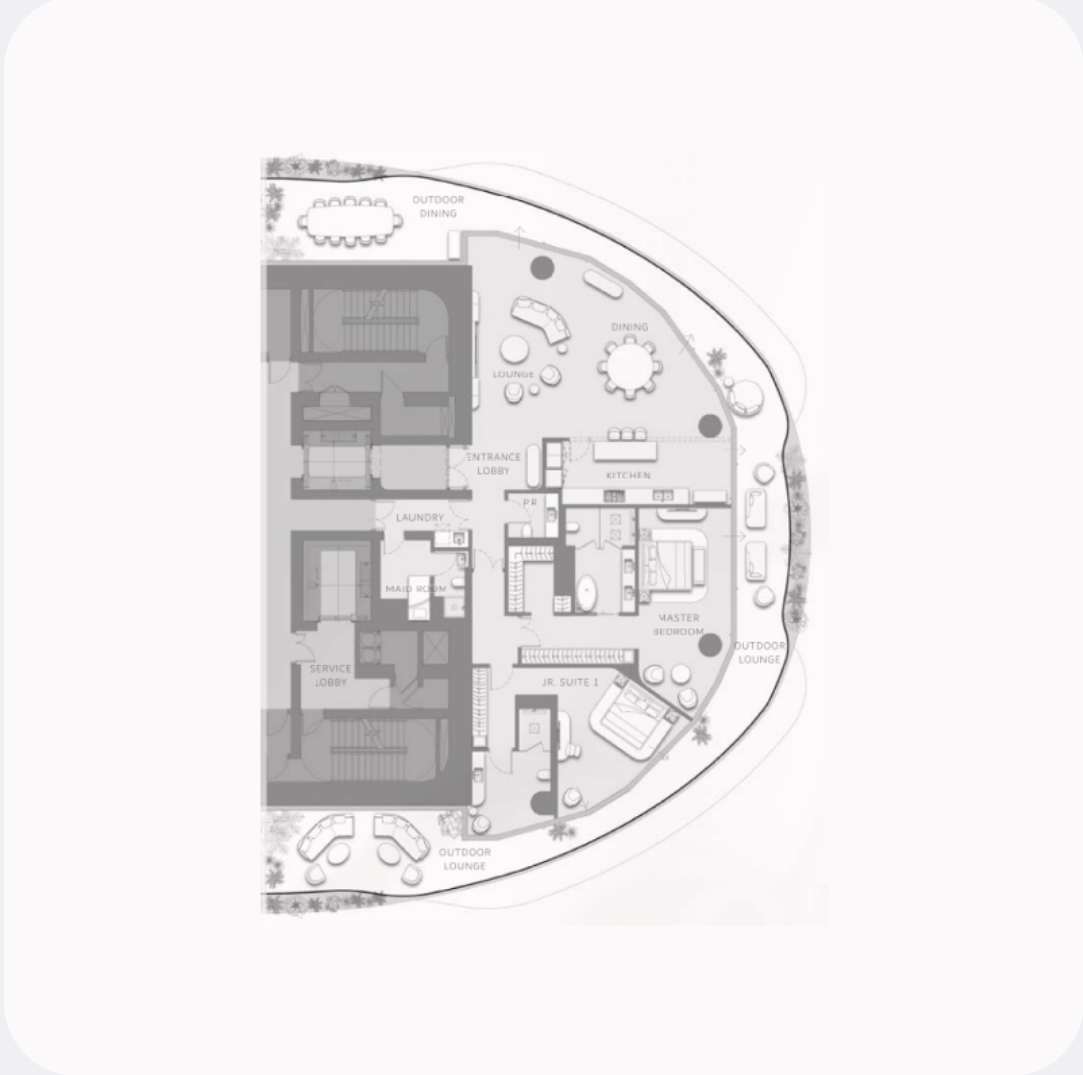

Apartments **2 bedroom**

FROM **No info** TO **No info**

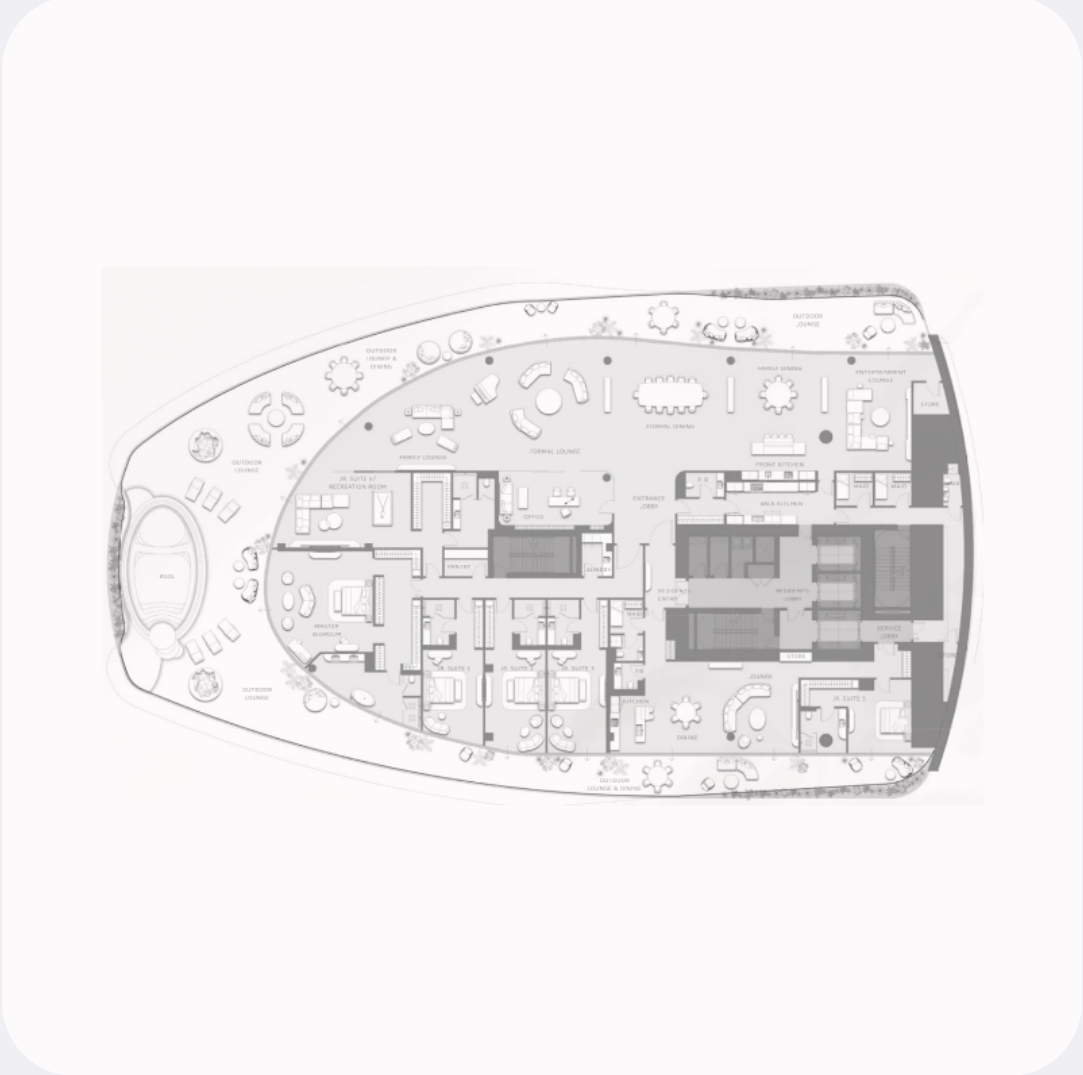

Apartments **6 bedroom**

FROM **No info** TO **No info**

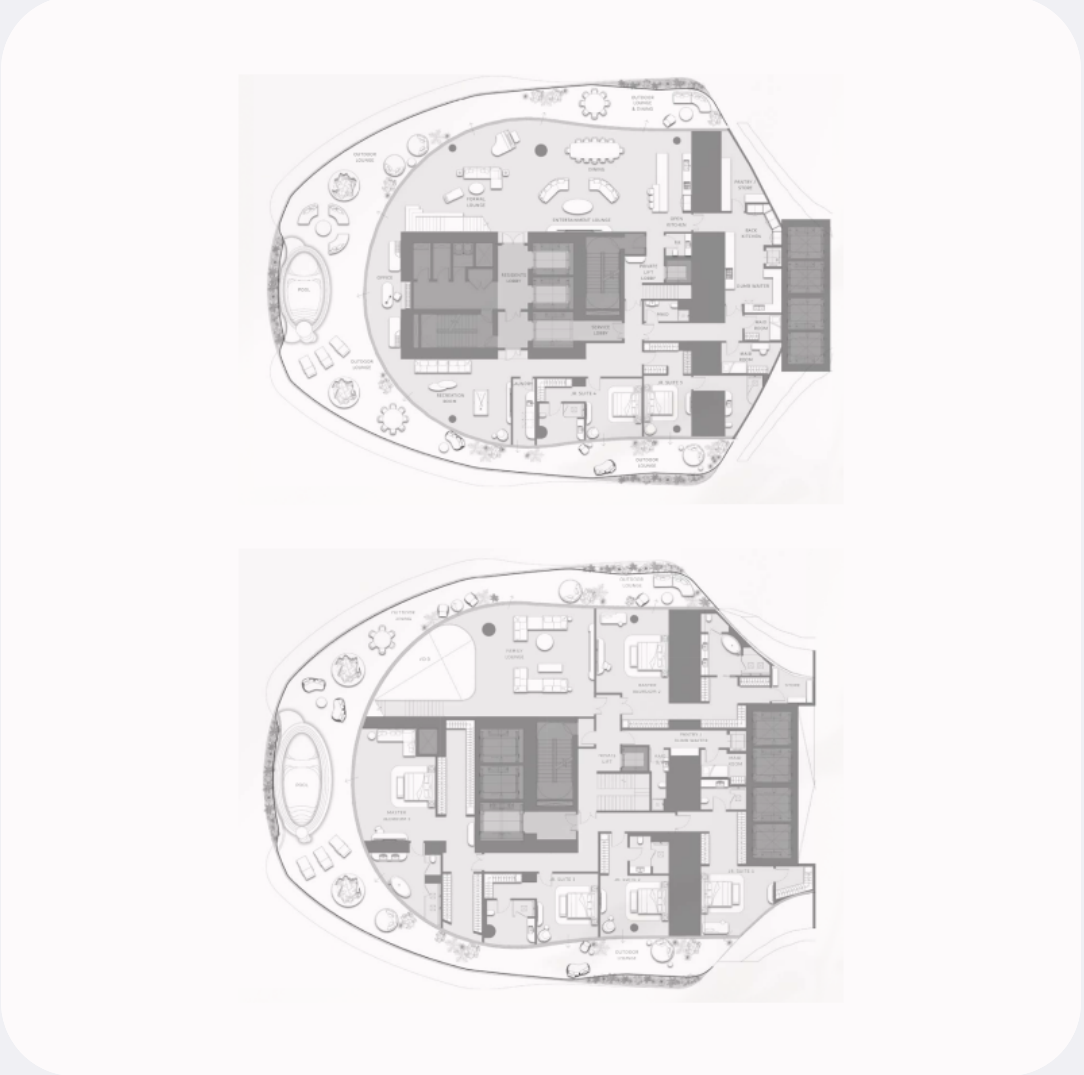

Apartments **7 bedroom**

FROM **No info** TO **No info**

Typical units and prices

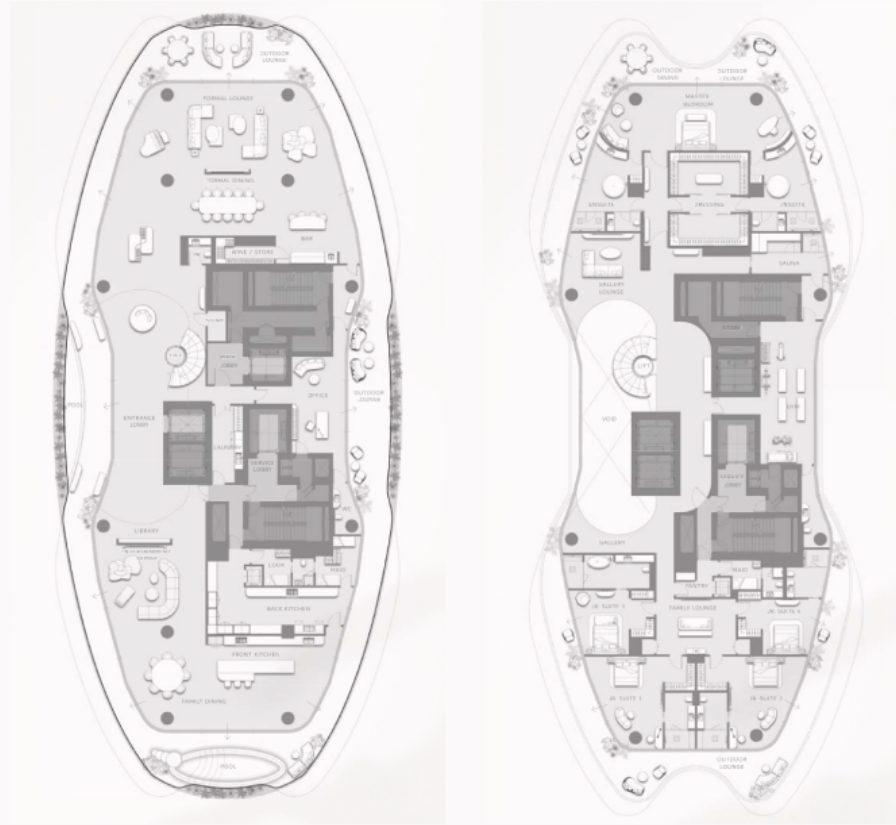

Penthouse

5 bedroom

FROM

No info

TO

No info

Do you have any questions? Contact me.

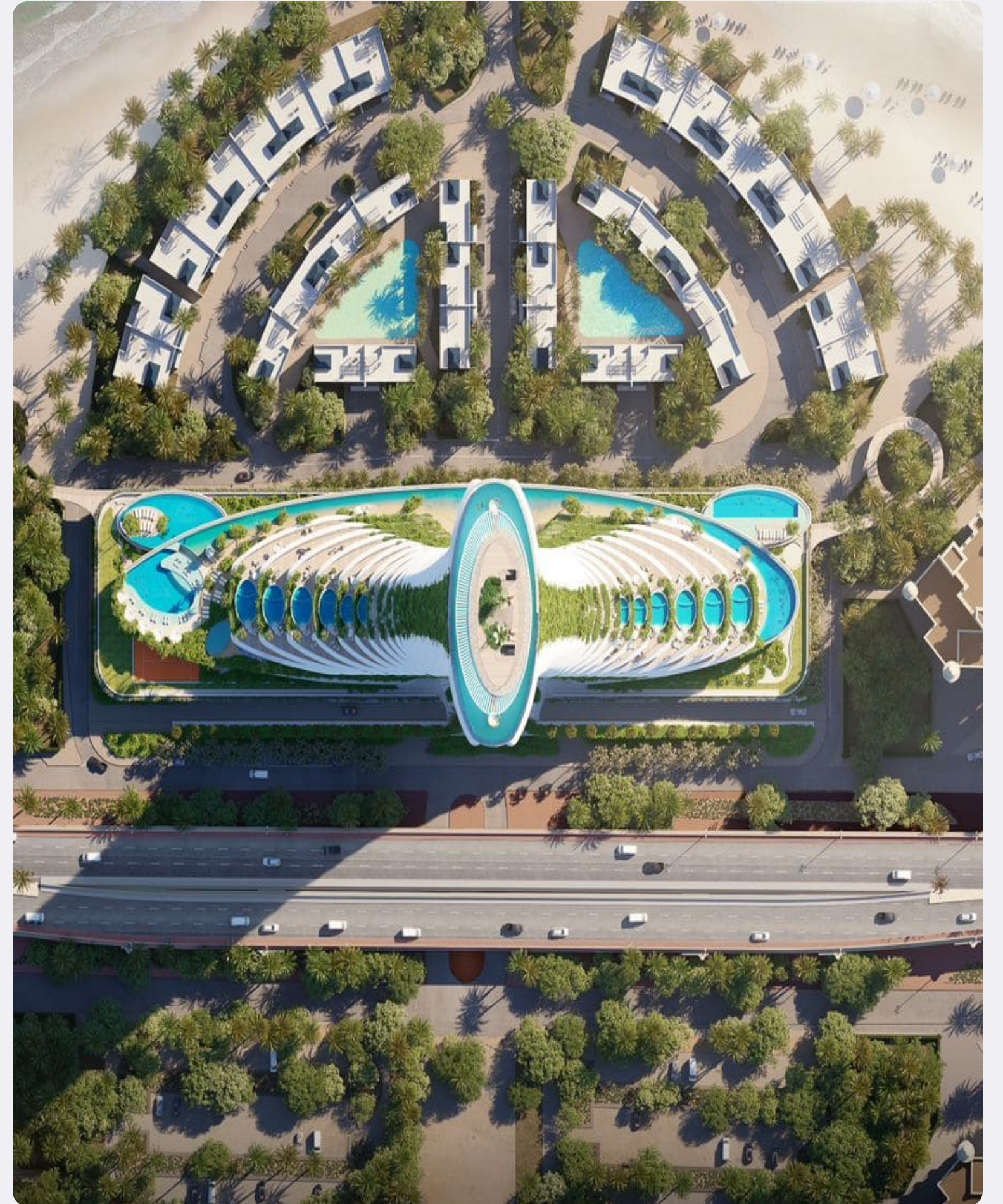

Jan Petrovic

Phone

+38640772980

Email

info@petrodeluxe.si

Instagram



WhatsApp



Email

